

TURBO-WSO PROTECT

Mineral wool insulation system with plaster based on nanotechnology.

Areas of application: For the implementation of insulation systems in housing, public and industrial construction For new and modernized buildings. Particularly suitable for buildings in the vicinity of tree stands, parks, forests, water reservoirs, coastal areas, industrial and urban agglomerations.

- Properties:**
- Waterproof
 - Frost-resistant
 - Water-repellent
 - Self-cleaning
 - Resistant to overgrowth
 - Vapor-permeable
 - UV-resistant
 - Eliminates thermal bridges
 - Very high durability
 - Rich color palette

Application procedure:

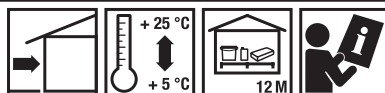

Technical data	
Packaging type	①
Quantity per unit	1 Piece
Layer thickness	50 - 250 mm
Reaction to fire (EN 13501-1)	A2-s1, d0
Adhesion to (Concrete)	≥ 0.25 MPa
Adhesion to (mineral wool)	≥ 0.08 MPa
sd value	≤ 0.29 m
Resistance to impact	Single mesh: category II, double mesh: category I
Water absorption	0.5 kg/m ²

The product conforms to: • European technical assessment ETA 15/0575

- Material base:**
- LEPSTYR-W 230/ STYRLEP-W 240/ STYRLEP-B 225
 - Mineral wool, mechanical fasteners, reinforcing mesh
 - STYRLEP-W 240/ STYRLEP-B 225
 - TYNKOLIT-U 340
 - SILIKON PROTECT 031

Surface: All substrates must have adequate load-bearing capacity, solid and compact structure and be cleaned of dust, grease, lubricants, release agents, paint residues, etc. Unstable coatings and coatings with insufficient adhesion must be removed. Oily and lubricated surfaces should be washed with detergent, infected with mold, moss, algae should be covered with SEPTOBUD 1008 and then washed under high pressure or mechanically removed.

Types of substrate:

- Bricks and ceramic CMUs:** Prime with GRUNTOLIT-W 301 or EXPERT 6
- Silicate blocks:** Prime with GRUNTOLIT-W 301 or EXPERT 6
- Autoclaved aerated concrete elements:** Prime with GRUNTOLIT-SG 302 or EXPERT 5
- Concrete and concrete blocks:** Prime with GRUNTOLIT-W 301 or EXPERT 6
- Concrete, reinforced concrete:** clean and possibly prime with GRUNTOLIT-SG 302
- Old plasters:** Prime with GRUNTOLIT-SG 302 or EXPERT 5
- Old paint coats:** Incompatible

Instructions: Protect against frost, precipitation, excessive drying during the execution of works and drying. Do not apply scaffolding covers.

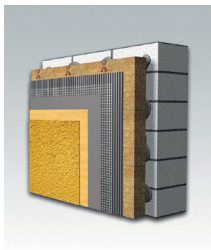

TURBO-WSO PROTECT

Mineral wool insulation system with plaster based on nanotechnology.

General information:

The complete set of thermal insulation system must be applied.

This product data sheet replaces all its previous versions. The information, included in this technical card, represents our current knowledge and practical experience. This is general information only which shall not obligate the manufacturer to take any responsibility either for workmanship or for the manner of use. For there may be differences and specific execution conditions. The product shall be applied in accordance with required technical knowledge and OHS rules. Avoid contact with skin and protect eyes. In case of contact with eyes, rinse them up with a large quantity of clean water and consult a doctor. It shall be recommended to use gloves, safety goggles and protective clothing.